

SHEET 1 OF 4

SHEET 2 OF 4

SHEET 3 OF 4

SHEET 4 OF 4

INSET A

INSET B

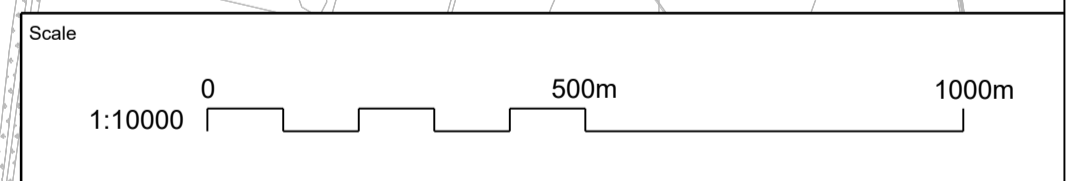

- NOTES**
1. ALL DIMENSIONS ARE IN METRES UNLESS STATED OTHERWISE
  2. THESE PLANS SHOULD BE READ IN CONJUNCTION WITH OTHER PLANS AND DOCUMENTS IN THE DEVELOPMENT CONSENT ORDER, IN PARTICULAR THE BOOK OF REFERENCE.

**KEY**

— DEVELOPMENT CONSENT ORDER (DCO) BOUNDARY

Project Title  
**A303 SPARKFORD TO ILCHESTER DUALLING**

Drawing Title  
**FIGURE 2.9  
CONSTRUCTION STRATEGY  
KEY PLAN**

Drawing Status: **Published - DEFINITION** Suitability: **A3**

Scale	Designed	Drawn	Checked	Approved
1:2500	MH	SP	CS	ER

Original Size	Date	Date	Date	Date
A1	22/05/20	16/07/18	16/07/18	16/07/18

Drawing Number: **HE551507 - MMSJV** | Originator: **- LSI -** | Volume: **000** | Project Ref. No.: **389107**

Revision: **C01**

REV.	DATE	AMENDMENT DETAILS	ORIG	CHKD	APPD
P01	16/07/18	DCO SUBMISSION	SP	CS	ER

THIS DOCUMENT IS ISSUED FOR THE PARTY WHICH COMMISSIONED IT AND FOR SPECIFIC PURPOSES CONNECTED WITH THE CAPTIONED PROJECT ONLY. IT SHOULD NOT BE RELIED UPON BY ANY OTHER PARTY OR USED FOR ANY OTHER PURPOSE. WE ACCEPT NO RESPONSIBILITY FOR THE CONSEQUENCES OF THIS DOCUMENT BEING RELIED UPON BY ANY OTHER PARTY, OR BEING USED FOR ANY OTHER PURPOSE, OR CONTAINING ANY ERROR OR OMISSION WHICH IS DUE TO AN ERROR OR OMISSION IN DATA SUPPLIED TO US BY OTHER PARTIES.

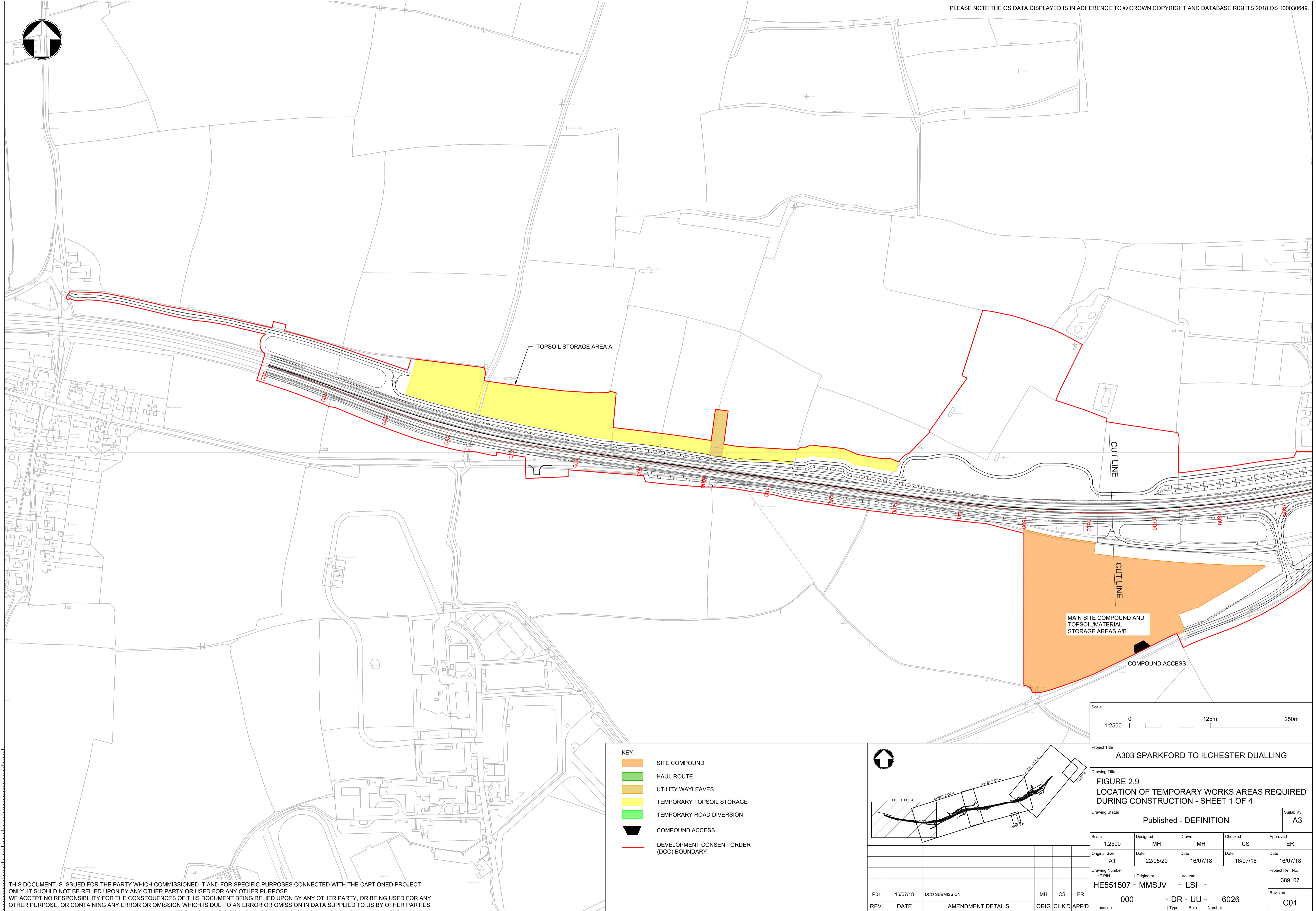
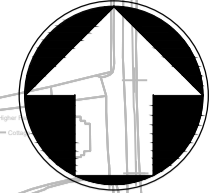

- KEY:**
- SITE COMPOUND
  - HAUL ROUTE
  - UTILITY WAYLEAVES
  - TEMPORARY TOPSOIL STORAGE
  - TEMPORARY ROAD DIVERSION
  - COMPOUND ACCESS
  - DEVELOPMENT CONSENT ORDER (DCO) BOUNDARY

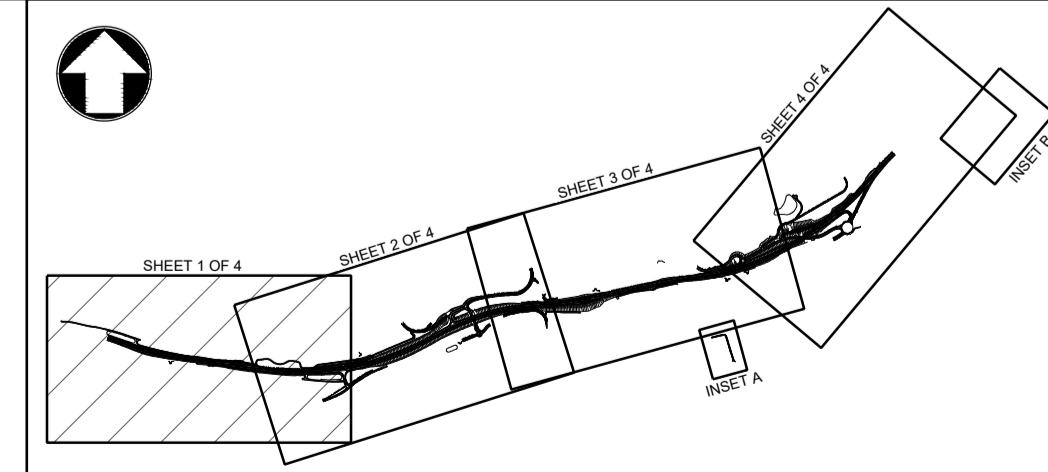

Scale 1:2500 0 125m 250m					
Project Title <b>A303 SPARKFORD TO ILCHESTER DUALLING</b>					
Drawing Title <b>FIGURE 2.9 LOCATION OF TEMPORARY WORKS AREAS REQUIRED DURING CONSTRUCTION - SHEET 1 OF 4</b>					
Drawing Status <b>Published - DEFINITION</b>					Suitability <b>A3</b>
Scale 1:2500	Designed MH	Drawn MH	Checked CS	Approved ER	
Original Size A1	Date 22/05/20	Date 16/07/18	Date 16/07/18	Date 16/07/18	
Drawing Number HE PIN <b>HE551507 - MMSJV - LSI -</b>			Volume <b>- LSI -</b>		Project Ref. No. <b>389107</b>
000			- DR - UJ - 6026		Revision <b>C01</b>
REV.	DATE	AMENDMENT DETAILS	ORIG	CHKD	APPD

THIS DOCUMENT IS ISSUED FOR THE PARTY WHICH COMMISSIONED IT AND FOR SPECIFIC PURPOSES CONNECTED WITH THE CAPTIONED PROJECT ONLY. IT SHOULD NOT BE RELIED UPON BY ANY OTHER PARTY OR USED FOR ANY OTHER PURPOSE. WE ACCEPT NO RESPONSIBILITY FOR THE CONSEQUENCES OF THIS DOCUMENT BEING RELIED UPON BY ANY OTHER PARTY, OR BEING USED FOR ANY OTHER PURPOSE, OR CONTAINING ANY ERROR OR OMISSION WHICH IS DUE TO AN ERROR OR OMISSION IN DATA SUPPLIED TO US BY OTHER PARTIES.

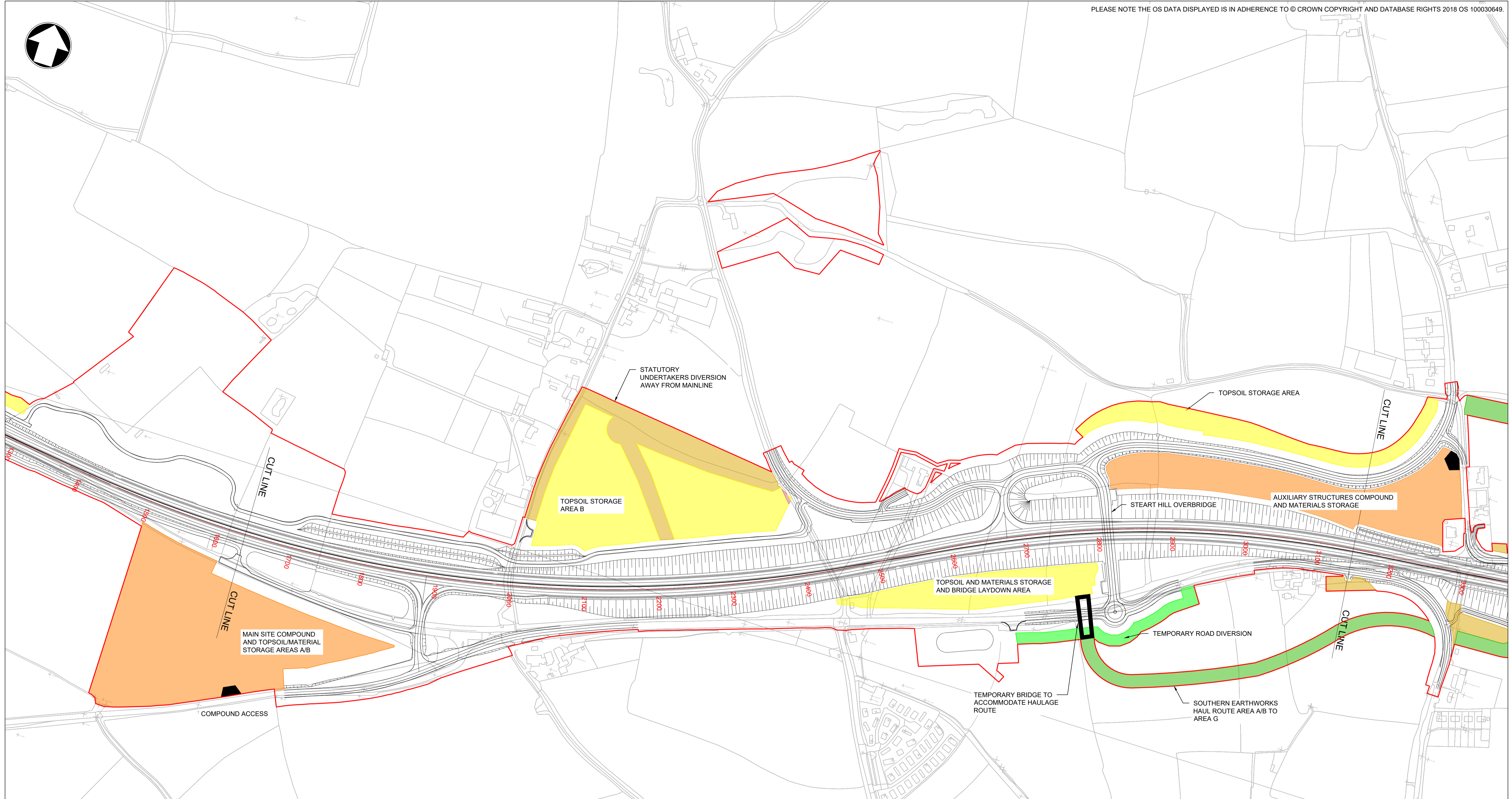
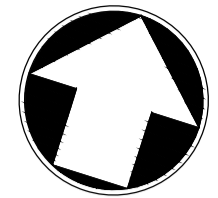

100  
90  
80  
70  
60  
50  
40  
30  
20  
10  
0

- KEY:**
- SITE COMPOUND
  - HAUL ROUTE
  - UTILITY WAYLEAVES
  - TEMPORARY TOPSOIL STORAGE
  - TEMPORARY ROAD DIVERSION
  - COMPOUND ACCESS
  - DEVELOPMENT CONSENT ORDER (DCO) BOUNDARY

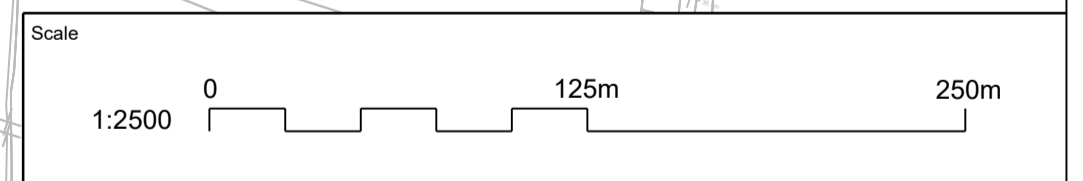
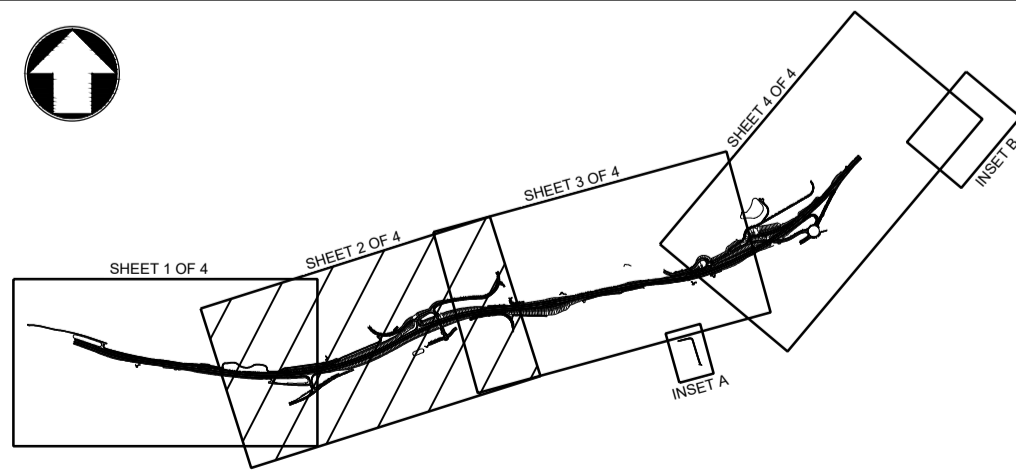

Project Title  
**A303 SPARKFORD TO ILCHESTER DUALLING**

Drawing Title  
**FIGURE 2.9  
LOCATIONS OF TEMPORARY WORKS AREAS REQUIRED  
DURING CONSTRUCTION - SHEET 2 OF 4**

Drawing Status: **Published - DEFINITION**      Suitability: **A3**

Scale	1:2500	Designed	MH	Drawn	MH	Checked	CS	Approved	ER
Original Size	A1	Date	22/05/20	Date	16/07/18	Date	16/07/18	Date	16/07/18

Drawing Number	HE PIN	Originator	Volume	Project Ref. No.
000	- DR - UU -	6027		389107
Revision				C01

REV.	DATE	AMENDMENT DETAILS	ORIG	CHKD	APP'D
P01	16/07/18	DCO SUBMISSION	MH	CS	ER

THIS DOCUMENT IS ISSUED FOR THE PARTY WHICH COMMISSIONED IT AND FOR SPECIFIC PURPOSES CONNECTED WITH THE CAPTIONED PROJECT ONLY. IT SHOULD NOT BE RELIED UPON BY ANY OTHER PARTY OR USED FOR ANY OTHER PURPOSE. WE ACCEPT NO RESPONSIBILITY FOR THE CONSEQUENCES OF THIS DOCUMENT BEING RELIED UPON BY ANY OTHER PARTY, OR BEING USED FOR ANY OTHER PURPOSE, OR CONTAINING ANY ERROR OR OMISSION WHICH IS DUE TO AN ERROR OR OMISSION IN DATA SUPPLIED TO US BY OTHER PARTIES.

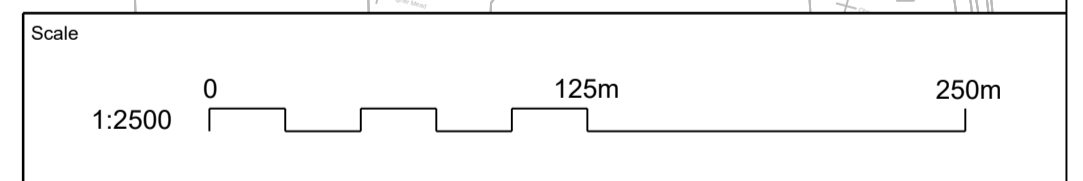
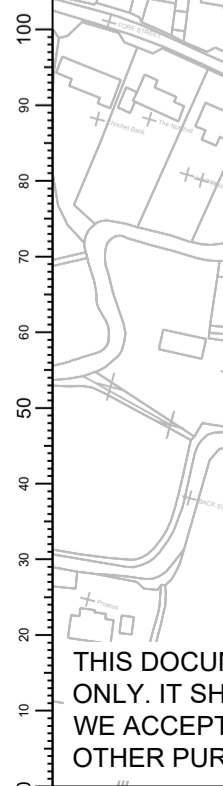
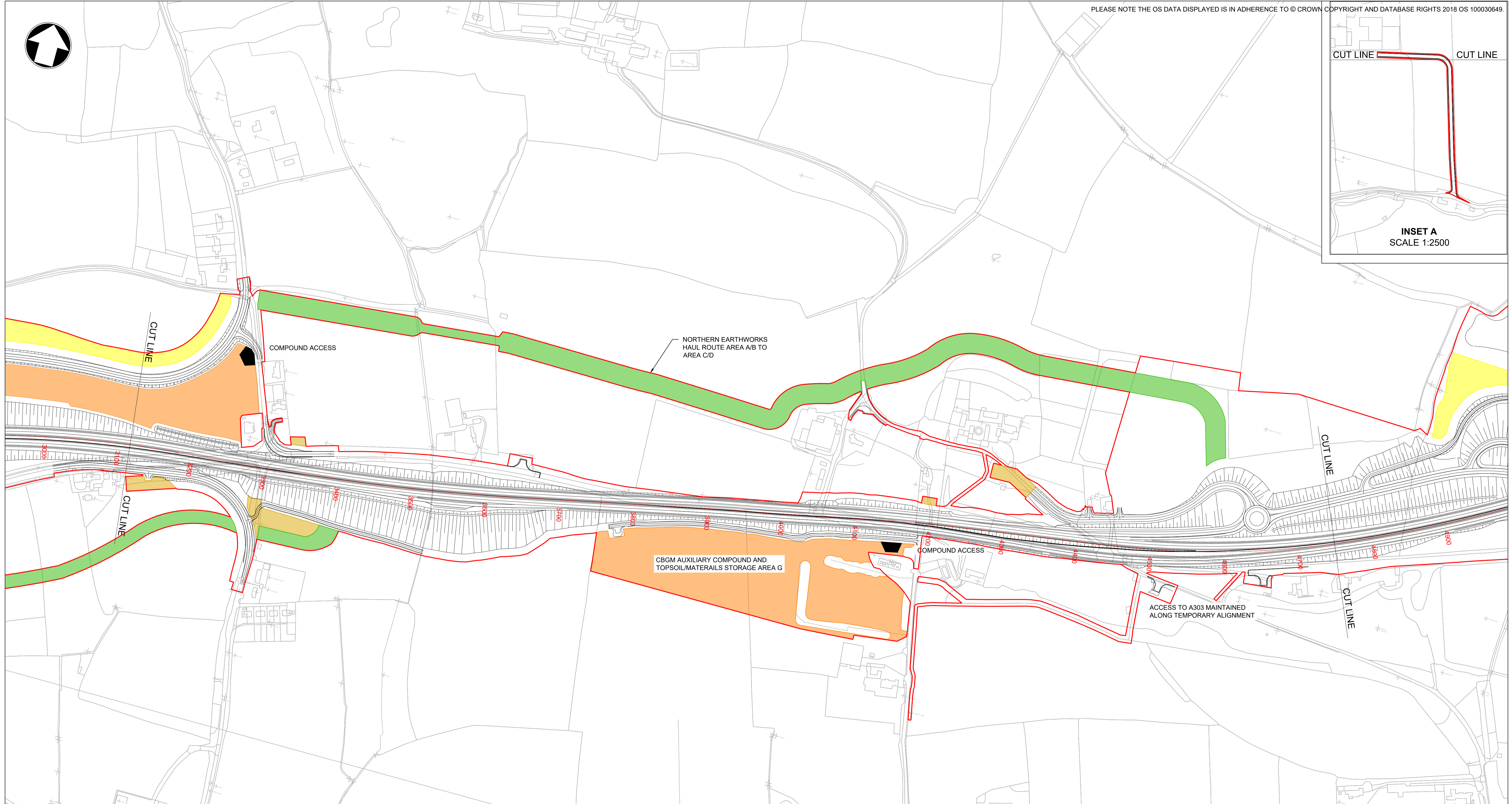
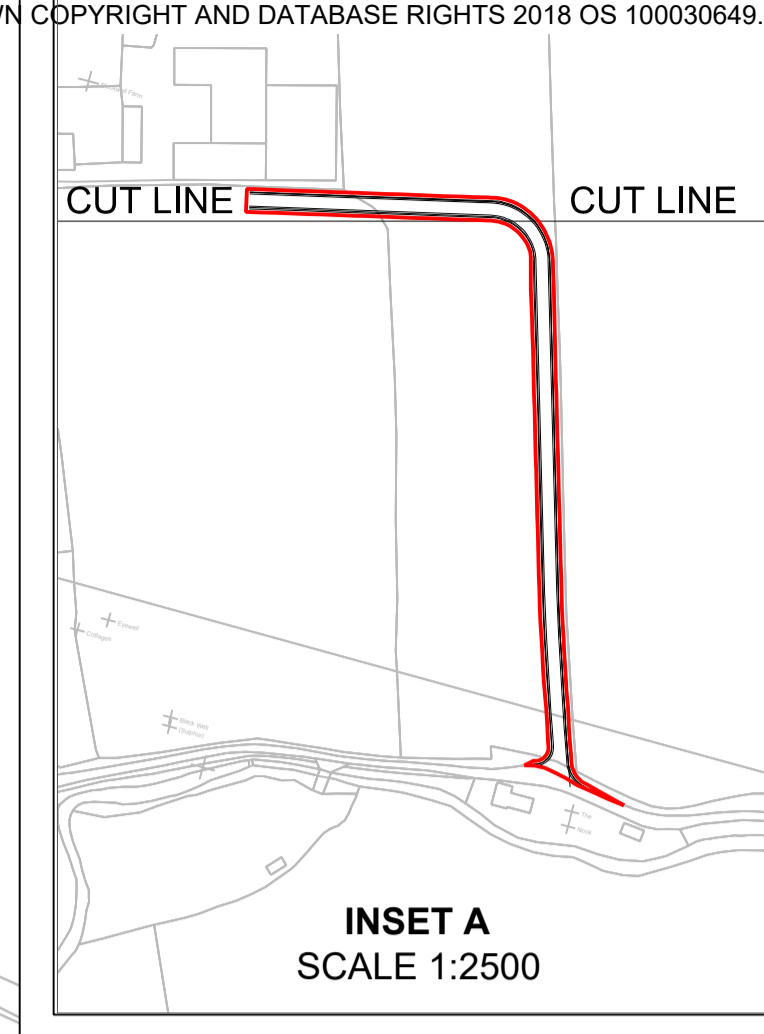
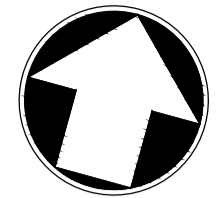

**KEY:**

- SITE COMPOUND
- HAUL ROUTE
- UTILITY WAYLEAVES
- TEMPORARY TOPSOIL STORAGE
- TEMPORARY ROAD DIVERSION
- COMPOUND ACCESS
- DEVELOPMENT CONSENT ORDER (DCO) BOUNDARY

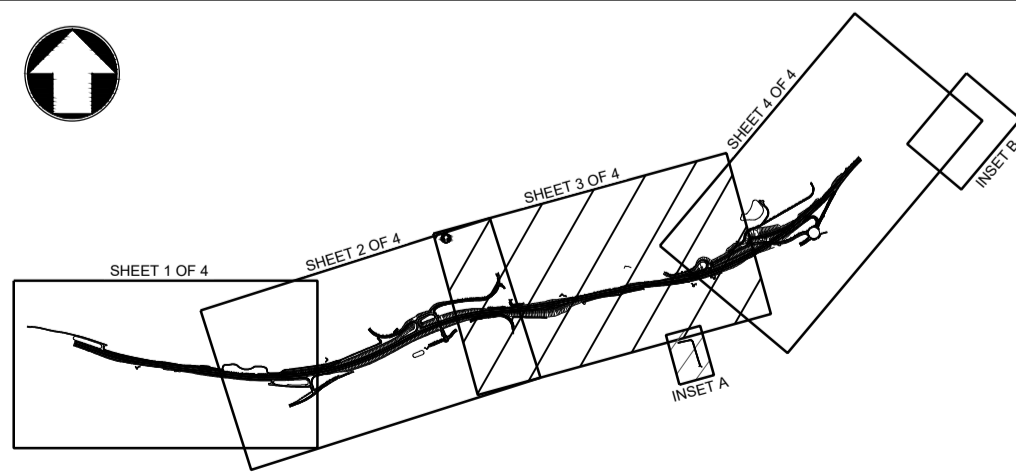

Project Title <b>A303 SPARKFORD TO ILCHESTER DUALLING</b>					
Drawing Title <b>FIGURE 2.9 LOCATIONS OF TEMPORARY WORKS AREAS REQUIRED DURING CONSTRUCTION - SHEET 3 OF 4</b>					
Drawing Status <b>Published - DEFINITION</b>					Suitability <b>A3</b>
Scale <b>1:2500</b>	Designed <b>MH</b>	Drawn <b>MH</b>	Checked <b>CS</b>	Approved <b>ER</b>	
Original Size <b>A1</b>	Date <b>22/05/20</b>	Date <b>16/07/18</b>	Date <b>16/07/18</b>	Date <b>16/07/18</b>	
Drawing Number <b>HE PIN</b>	Originator <b>HE551507 - MMSJV</b>	Volume <b>- LSI -</b>		Project Ref. No. <b>389107</b>	
<b>P01</b>	<b>16/07/18</b>	<b>DCO SUBMISSION</b>	<b>MH</b>	<b>CS</b>	<b>ER</b>
<b>REV.</b>	<b>DATE</b>	<b>AMENDMENT DETAILS</b>	<b>ORIG</b>	<b>CHKD</b>	<b>APP'D</b>
			<b>000</b>	<b>- DR - UJ -</b>	<b>6028</b>
			<b>Location</b>	<b>Type</b>	<b>Role</b>
			<b>C01</b>		

THIS DOCUMENT IS ISSUED FOR THE PARTY WHICH COMMISSIONED IT AND FOR SPECIFIC PURPOSES CONNECTED WITH THE CAPTIONED PROJECT ONLY. IT SHOULD NOT BE RELIED UPON BY ANY OTHER PARTY OR USED FOR ANY OTHER PURPOSE. WE ACCEPT NO RESPONSIBILITY FOR THE CONSEQUENCES OF THIS DOCUMENT BEING RELIED UPON BY ANY OTHER PARTY, OR BEING USED FOR ANY OTHER PURPOSE, OR CONTAINING ANY ERROR OR OMISSION WHICH IS DUE TO AN ERROR OR OMISSION IN DATA SUPPLIED TO US BY OTHER PARTIES.

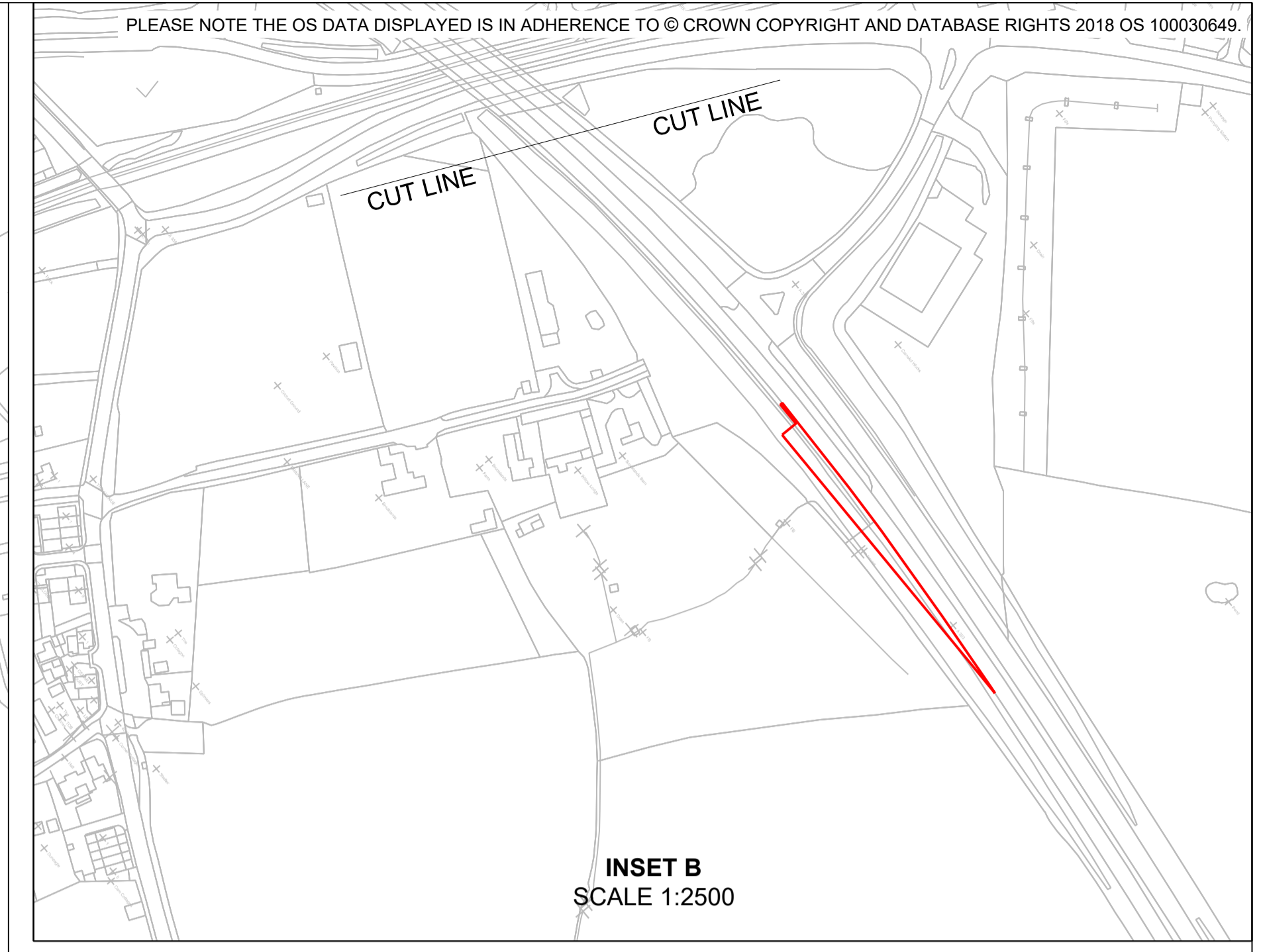
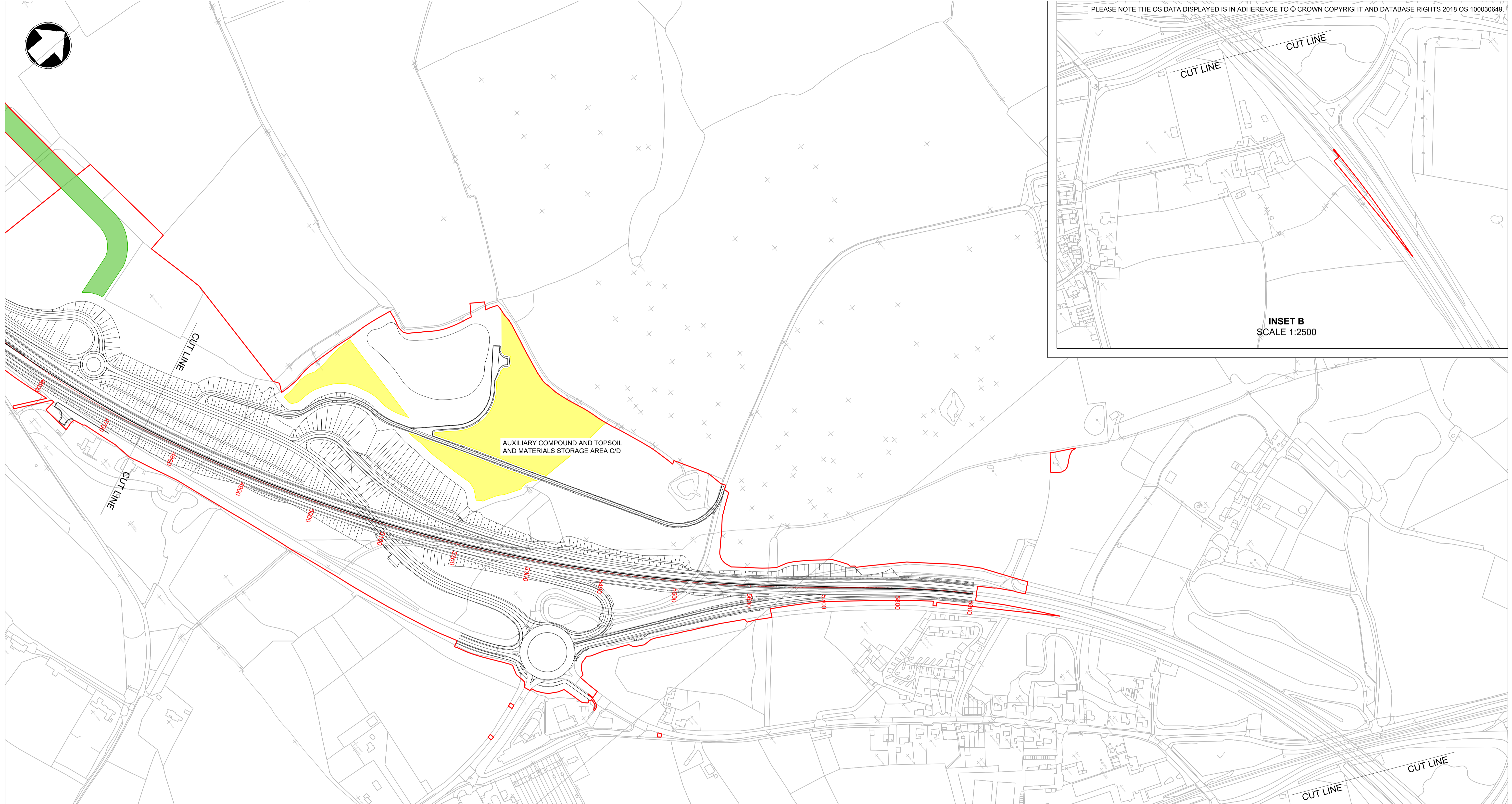

**INSET B**  
SCALE 1:2500

100  
90  
80  
70  
60  
50  
40  
30  
20  
10  
0

- KEY:**
- SITE COMPOUND
  - HAUL ROUTE
  - UTILITY WAYLEAVES
  - TEMPORARY TOPSOIL STORAGE
  - TEMPORARY ROAD DIVERSION
  - COMPOUND ACCESS
  - DEVELOPMENT CONSENT ORDER (DCO) BOUNDARY

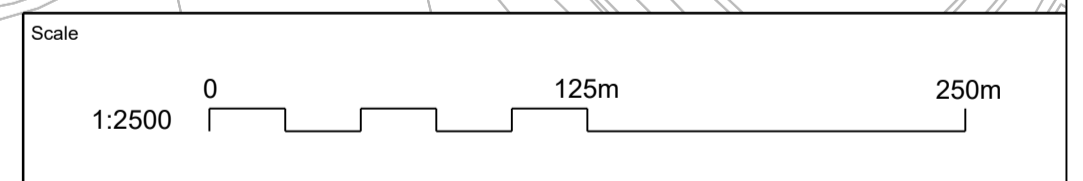
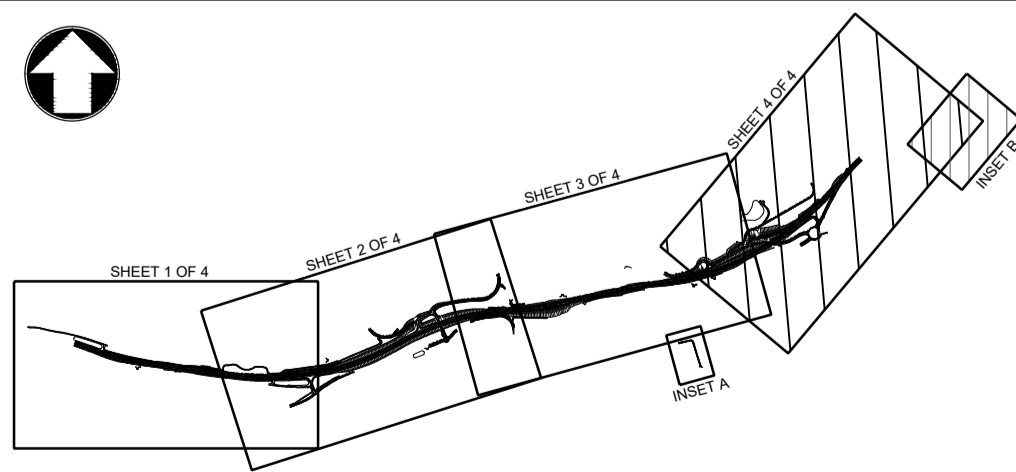

Project Title <b>A303 SPARKFORD TO ILCHESTER DUALLING</b>					
Drawing Title <b>FIGURE 2.9 LOCATIONS OF TEMPORARY WORKS AREAS REQUIRED DURING CONSTRUCTION - SHEET 4 OF 4</b>					
Drawing Status <b>Published - DEFINITION</b>					Suitability <b>A3</b>
Scale 1:2500	Designed MH	Drawn MH	Checked CS	Approved ER	
Original Size A1	Date 22/05/20	Date 16/07/18	Date 16/07/18	Date 16/07/18	
Drawing Number HE PIN	Originator MMSJV	Volume - LSI -	Project Ref. No. 389107		
P01	16/07/18	DCO SUBMISSION	MH	CS	ER
REV.	DATE	AMENDMENT DETAILS	ORIG	CHKD	APPD
000			- DR - UU - 6029		
Location			Type   Role   Number		
			<b>C01</b>		

THIS DOCUMENT IS ISSUED FOR THE PARTY WHICH COMMISSIONED IT AND FOR SPECIFIC PURPOSES CONNECTED WITH THE CAPTIONED PROJECT ONLY. IT SHOULD NOT BE RELIED UPON BY ANY OTHER PARTY OR USED FOR ANY OTHER PURPOSE. WE ACCEPT NO RESPONSIBILITY FOR THE CONSEQUENCES OF THIS DOCUMENT BEING RELIED UPON BY ANY OTHER PARTY, OR BEING USED FOR ANY OTHER PURPOSE, OR CONTAINING ANY ERROR OR OMISSION WHICH IS DUE TO AN ERROR OR OMISSION IN DATA SUPPLIED TO US BY OTHER PARTIES.